

# MUELLER®

**MODEL: BU-P5167-\***

**Banana Jack (In-Line)**

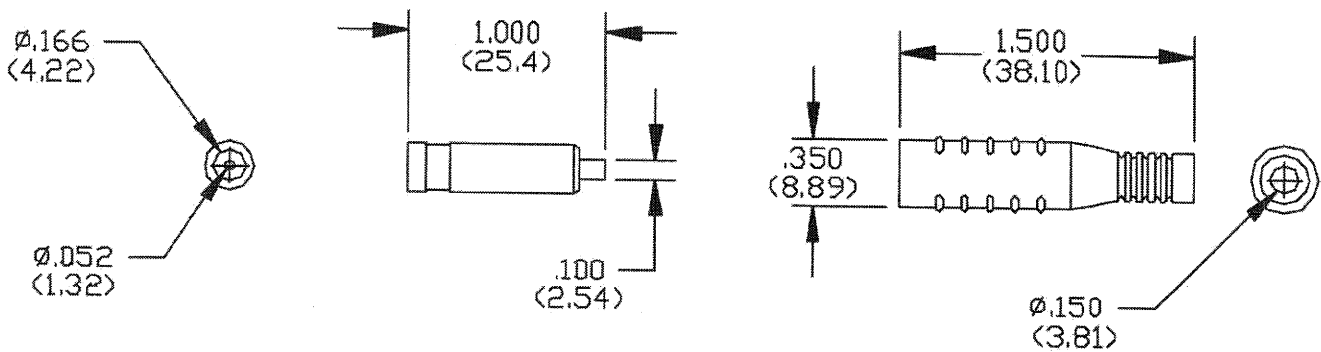

## MATERIALS:

Body – Nickel Plated Brass

Insulator – Flexible PVC. Comes in -0 Black, -2 Red

For use with 18AWG, 20AWG, and 22AWG wires. Can be soldered or crimped

## RATING:

15 Amps

Hands free testing to 5000 VDC max.

Temperature:  $-70^{\circ}\text{C}$  to  $50^{\circ}\text{C}$